

1205A
STUDENT
UNION

ready. set. BUILD.

| EDUCATIONAL FACILITIES |

SHOCKEY

THE PARTNER OF CHOICE®

Quality Construction Since 1896



Wakefield School, THE PLAINS, VA

It's a fact: Environment enhances learning. Learning is affected by physical factors such as building age and condition, visual factors and lighting. School spaces designed to maximize efficiency in all types of things—things like circulation, access and multi-use—allow more time and energy for learning activities.

With projects come questions. The “right” answer is different based on the specific situation that the school faces. A classroom designed for a particular district’s computerization plan, for instance, allows for precise wiring, lighting and configuration of spaces that work correctly from the very first day of occupancy through the facility’s life cycle, as technology and needs change.

You may have your own questions. What sets Howard Shockey and Sons, Inc. apart for educational facilities construction? Why do our clients view us as The Partner of Choice®?

We’ve been building for more than a century. Because we’ve been around since 1896, our experience tells us that the traditional idea of a “classroom” has grown and changed. We’ve been along for the ride every step of the way.

The growth of computer-based instruction, video projection and other telecommunication requirements has helped us rethink traditional educational patterns and spatial relationships and our role in constructing appropriate facilities. We know that a school that emphasizes science and math will have very different needs from one that focuses on the arts.

Shockey always pays close attention to safety and security issues and environmental quality. With LEED APs on staff, we understand strategies such as daylighting, working with sustainable and non-toxic building materials and the use of renewable energy sources in school construction.

Yet, adequate resources for the construction, maintenance and upkeep of educational facilities seem to remain in short supply. So, what’s the answer?

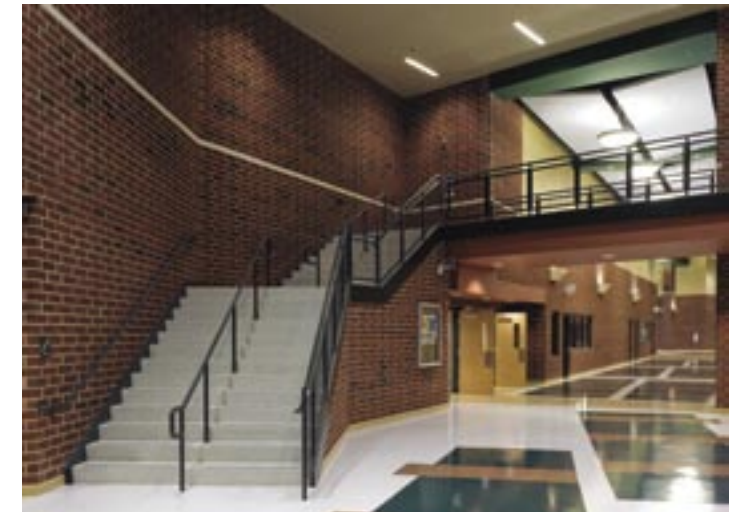

Kettle Run High School, Nokesville, VA



Byrd Middle School, WINCHESTER, VA



John Handley High School, WINCHESTER, VA

too cool for school

CLASSIC DESIGN MEETS MODERN TECHNOLOGY Traditional classroom? Special-needs classroom? Science laboratory facilities? All of the above? Whether a design-build project, a hard bid or a PPP, school construction can get pretty messy. Choose Shockey—the contractor that’s experienced enough to build any project. We can meet all of your needs. We’ve been building since 1896, and we have the experience and know-how to construct the exact structure you need for your unique situation. With Shockey as your builder, your educational facility will definitely **make the grade.**

.....
room to grow
We can help you create a great space that can easily adapt and grow with you as your needs change.



James Wood Middle School, WINCHESTER, VA



Highland School Center for the Arts, THE PLAINS, VA



West Warren County High School, FRONT ROYAL, VA

In addition to hard-bid procurement and design-build, one very real answer might lie in the Commonwealth of Virginia's PPEA statute.

As builders, Howard Shockey & Sons, Inc. believes it is our core responsibility to identify and pursue options that provide opportunities both for us and for our public and private sector clients.

Virginia's PPEA statute allows Shockey to truly act as a partner: It is a mechanism for additional revenue sources and financing options—a real answer for public organizations, like schools, who want to share costs and risks with a private-sector development organization.

Partnerships respond to the public need for adequate facilities (provided in a timely fashion), which may or may not be wholly satisfied by existing methods of procurement. By exercising the procurement option of competitive negotiation/design-build, public entities may receive the benefits of a shorter turnaround time and the potential for lower overall project costs.

In Virginia, PPEA takes design-build more readily to the public realm. Most any project that serves a public need can qualify for PPEA: any building for principal use by a public entity, any equipment or improvements necessary to enhance public safety or security, communications infrastructure, technology or recreational facilities—and any facility that is operated as part of a public school system or as an institution of higher education.

Howard Shockey was one of the first general contractors to embrace the concept of public-private partnership (PPP). As such, our focus has been on helping counties, towns, cities and school boards streamline the use of their resources and energies. Ultimately, we want to help all of our public customers discover the most efficient ways to build their specialized projects.

Our vision as an innovative leader in PPP construction and our commitment to excellence fit perfectly with our public customers' demands for timely, adequate facilities.



.....
so
happy
together.

Students have pride in attractive school facilities, feeling compelled to take care of them. Let Shockey build a nice structure for you and your community.

do your homework

FROM START TO FINISH We want you to have options, so we're always looking for (and finding) ideas that just might enhance learning. We strive to provide innovations in planning and construction that help facilitate education. We do our best to help you streamline your energy and resources. And we've been doing this for a long time, so we know the intricacies of school construction. Did someone say **learning curve?** No matter what you throw at Shockey, we have the experience to make it work.



Eastern View High School, CULPEPER, VA

What else sets Shockey apart for partnership? Our clients view us as The Partner of Choice® because we always do our homework. We've taken the best of what we know about construction and brought it to bear in the public eye.

As an early and frequent school builder, Howard Shockey has participated in hundreds of educational projects since its founding. Shockey has already built a substantial list of satisfied public and private educational partners.

Through our experience, we've confirmed that when the public need is met, our needs are met. The projects that best meet our public customers' needs are the ones that truly satisfy us. We believe in mutual success.

And as with everything else we do, safety, integrity, training and our ever-present concern for a quality product are hallmarks of a Shockey job. Our decades of experience in estimating and cost control and our expertise in building countless types of educational facilities doesn't hurt, either.

Knowing that environment can improve performance, Shockey has never underestimated the value of school facilities. School facilities are tangible symbols of a society's commitment to education, and we understand that the message is not lost on students. We have always known that a well-designed and constructed facility can revitalize a declining neighborhood. Students—as well as parents and community members—have pride in attractive structures and amenities and feel compelled to take care of them.

When selecting a contractor for your school's construction, make wise decisions. Ask the proper questions: What are your needs? Who has the experience to meet these needs? Most of all, who understands the ins and outs of school construction? Who will best help you make the grade?

Whether your project is a hard-bid, design-build or PPP, the 'right' answer will always be Shockey.



Highland School Center for the Arts, WARRENTON, VA



Musselman High School, BUNKER HILL, WV



East Warren County High School, FRONT ROYAL, VA

allow us to **WOW you**

SCHOOLS BUILT FOR FUTURE GENERATIONS Our ability and willingness to schedule and completely build your project—coupled with our understanding of the true scope of work—improves communication and helps alleviate misunderstandings. Plus, our experience in estimating and cost control and our expertise in school construction helps ensure that every step of the process goes smoothly. Let Shockey impress you with a structure that's **smart** enough to meet your needs.

.....
goal setting. We stand behind what we build. For more about our projects and promises visit www.howardshockey.com.

ready. set. BUILD.
| EDUCATIONAL FACILITIES |



Belmont Ridge Middle School, ASHBURN, VA

*all photography
by Eric Taylor
© EricTaylorPhoto.com*

Howard Shockey & Sons, Inc.
P.O. Box 2530
Winchester, VA 22604
540.667.7700

Quality Construction Since 1896

SHOCKEY
THE PARTNER OF CHOICE®

www.howardshockey.com